

BRETAGNE

Marine Renewable Energy

PORT OF BREST

A port dedicated to producing, storing and transporting large, heavy-load components (+ 2,000T).

Resources | Research | Industry | **Infrastructure** | Training



PORT OF BREST, A STRATEGIC LOCATION

Brest has become a genuine hub for developing Marine Renewables in Europe. It lies at the heart of the Atlantic-Channel and Irish Sea markets, and has sea, road and air transport infrastructure, making it an essential economic gateway.

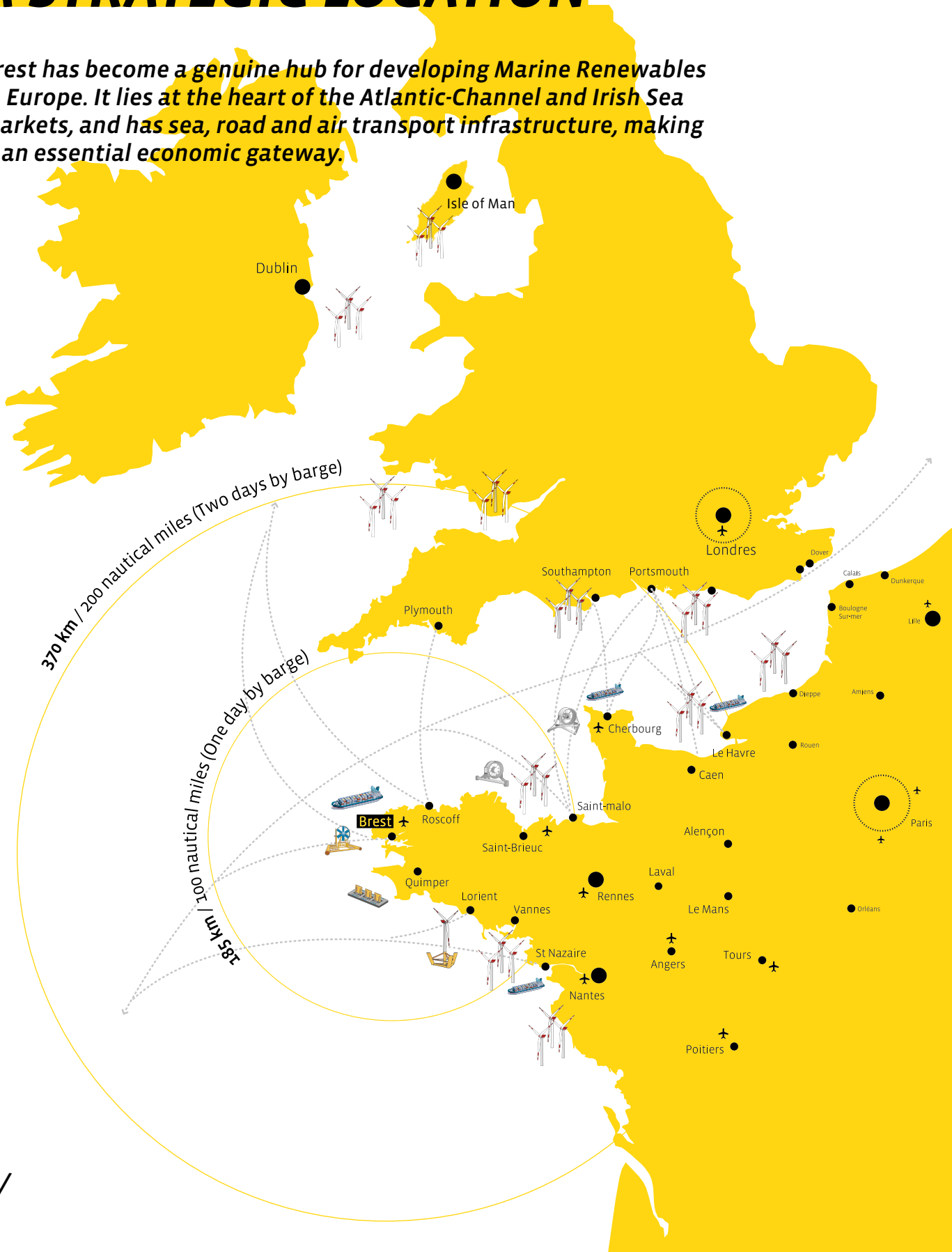



© Panoramic

PORT INFRASTRUCTURES ABLE TO HANDLE YOUR PROJECTS

Redevelopment of the port along with its adapted services will provide for the loading/unloading, production, storage and transport of large, heavy-load components (+ 2,000T).

/ Port specifications

- A 175x40m quay with 15 T/m² load capacity
- A 210x40m quay with 15 T/m² load capacity
- A 100m multi-purpose quay with 4 T/m² load capacity
- A handling platform of 1.3 ha with 15 T/m² load capacity
- Specific facilities for loading/unloading large, heavy-duty components
- Heavy-duty inner road areas for bulky components
- Reinforced surfaces with 4 T/m² load capacity (1% inclination)
- Various service and marshalling roads
- Road connections with large/heavy load capabilities
- Direct airport link, regular commercial flights
- Compliance with ISPS standards – industrial security (fenced compounds with controlled access)

/ Adapted services

- 24/7 access
- Pilotage
- Towing (3 permanent tugs)
- Workboat provision

A PORT DESIGNED FOR YOUR PROJECTS

One of the Port of Brest's strengths lies in its flexibility. **With 24/7 access**, everything has been designed with your requirements in mind whatever the time of day or night. This flexibility draws on the port's technical features, providing **ro-ro loading and unloading capacity for large, heavy-duty components**.

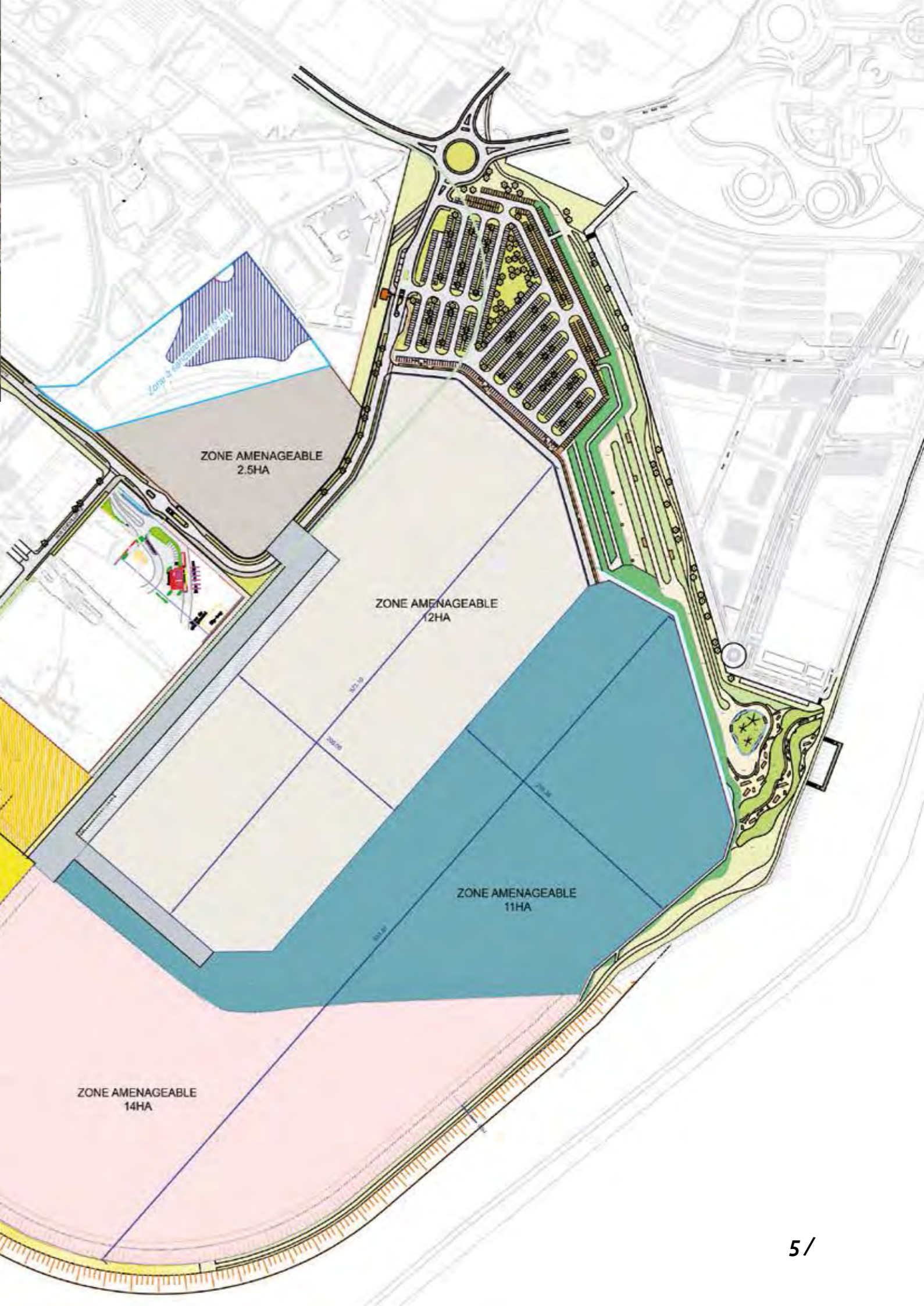

TECHNICAL CHARACTERISTICS

To boost the port's commercial growth and to accommodate new activities relating to Marine Renewables Energy, the Port of Brest is being reorganised and redeveloped in line with your ambitions.

TIMELINE

- 2015 / first 12 ha available
- 2017 / additional 11 ha available
- 2020 / additional 14 ha available

BREST, AN ATTRACTIVE LOCATION

Brest is located on one of the world's busiest shipping lanes, and can draw on a region that is ideal for setting up and developing industrial maritime activities.

/ A seaward-looking town

The town of Brest leveraged its ideal location and expertise to position itself as one of Europe's main ports for MRE development. It possesses a **400 000 strong labour market** and harnesses the strengths of research, high-tech businesses and industrial leaders. Internationally recognised for its skills and expertise in marine science and technology, **Brest concentrates 50% of France's research capacity**. It is home to leading MRE innovators, researchers and developers: France Énergies Marines, Ifremer, Pôle Mer Bretagne-Atlantique cluster, including many research laboratories and Grandes Ecoles such as ENSTA Bretagne.

As France's first port for naval fleet servicing and civilian ship repair, Brest is an ideal site for the logistic and industrial activities required by a national MRE industry. The skills base provided by local businesses, used for shipbuilding and maintenance, has already been called upon to develop and assemble the largest ever tidal stream turbine to date, Arcouest by EDF. It is this supportive eco-system that offers a natural setting for the growth of marine renewables.



/ A region at the cutting-edge of marine renewables

Thanks to its outstanding natural energy resource Bretagne has become a test-bed for marine energy. The region's energy potential derived from its strong marine currents, tides, ocean waves, and wind patterns has been tried and tested by research teams unique in Europe. **Site selection planning and consultation techniques** have been refined as a way of locating potential energy generation sites ("derisked" areas) and assessing the associated technical issues. This is based on deep insight developed since 2010 by regional and local government. In the region, training is available for all maritime and MRE trades. Extensive skills and knowledge from the maritime, shipbuilding and industrial sectors have been spread across the region's highly qualified workforce. **It is these advantages that undeniably make Bretagne an ideal setting in which to locate and develop industrial activity.**





EVERYTHING ON-HAND TO SUPPORT YOUR PROJECTS

To help you set up at the Port of Brest, we offer personalised and bespoke support and advice.

Come over to the site where infrastructure specialists will show you around. You will be given help with administration and we can put you in touch with employment and shipping agencies, regional businesses, networks and clusters.

/ Contacts

Eric Aubry

MRE and marine activities advisor
+00 33 (0)2 99 84 53 00 / e.aubry@bdi.fr

Lucile Héritier

Brest Port Development Project Manager
Région Bretagne
+00 33 (0)2 90 09 16 01 / lucile.heritier@region-bretagne.fr

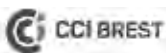

Syndicat Mixte pour le développement de Brest Iroise